



Specifications of the **ExTra** laser system for **Micro-Invasive Glaucoma Surgery (MIGS)**



ExTra: The ophthalmic laser system for to perform the **micro-invasive** ELT-procedure (**Excimer Laser Trabeculostomy**) of open-angle glaucoma

Laser type	XeCl Excimer Laser
Wavelength	308 nm
Laser class	4
Energy at distal end	1,3 mJ
Repetition rate	20 Hz
Static gas lifetime	approx. 12 months
Voltage / power consumption	90 – 240 VAC 50 – 60 Hz 70 – 100 VA
Footprint (L x W x H)	approx. 740 mm x 580 mm x 870 mm
Weight	approx. 75 kg
Compliance	CE conformity to MDD 93/42/EC Identification number: 0197

Contact

MLase AG
Industriestrasse 17
82110 Germering

Telefon: +49 (0) 89 / 693 377-0
Fax: +49 (0) 89 / 693 377-10
Email: info@mlase.com
Internet: www.mlase.com



Specifications of the **FIDO** (Laser Applicator) for the **ExTra** Laser System / **ELT-Procedure**

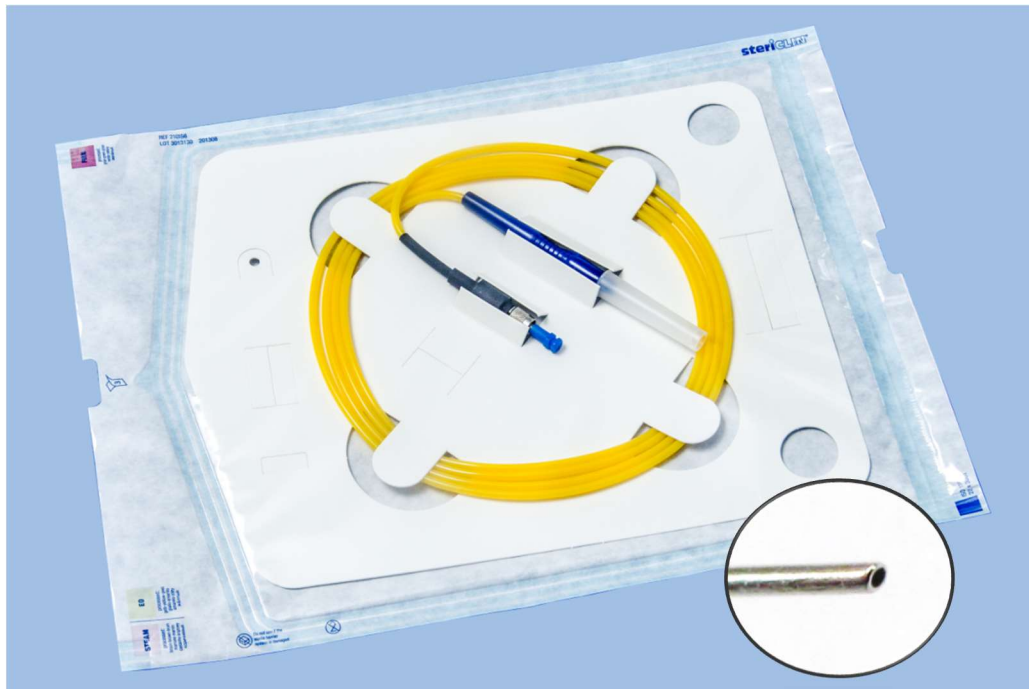

The **FIDO Laser Applicator** conducts the light of the **ExTra** to the trabecular meshwork via a metal-jacketed fiber end.

Overall length	200 cm
Length of handpiece	7 cm Tactile index identification for detection of the cannula bevel
Cannula	Stainless steel cannula with a diameter of 0,5 mm Cannula protrudes 35 mm from the handpiece 25° distally bevel
Effective Fiber-Diameter	0,21 mm
Optical properties	Numerical Aperture 0,22
Length of Sterile-adapter	4,4 cm (avoids contamination of the applicator during energy check)
General	Detection via RFID chip Sterile product for single use

Contact

MLase AG
Industriestrasse 17
82110 Germering

Telefon: +49 (0) 89 / 693 377-0
Fax: +49 (0) 89 / 693 377-10
Email: info@mlase.com
Internet: www.mlase.com